

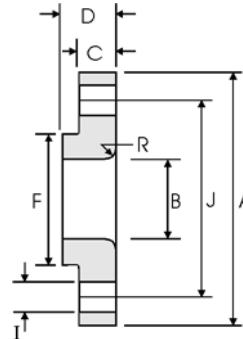

Lap Joint Flanges - ANSI B16.5



Class 900 lb

| Nominal Pipe Size | Pipe | Flange Data | | | | | Lap | Hub | Drilling Data | | | Weight |
|-------------------|---|------------------|-----------------|----------------------|----------------|------------|--------------|-----------------|--------------------|-----------------------------|---|--------|
| |  | A | B | C | D | R | F | H | I | J |  | |
| | Outside Diameter | Overall Diameter | Inside Diameter | Flange Thickness min | Overall Length | Lap Radius | Hub Diameter | Number of Holes | Bolt Hole Diameter | Diameter of Circle of Holes | kg/ piece | |
| | in mm | in mm | in mm | in mm | in mm | in mm | in mm | | in mm | in mm | | |
| 1/2 | 0.840 | 4.750 | 0.900 | 0.880 | 1.250 | 0.120 | 1.500 | 4 | 0.880 | 3.250 | 1.71 | |
| | 21.30 | 120.6 | 22.90 | 22.30 | 31.70 | 3.000 | 38.10 | | 22.30 | 82.50 | | |
| 3/4 | 1.050 | 5.120 | 1.110 | 1.000 | 1.380 | 0.120 | 1.750 | 4 | 0.880 | 3.500 | 2.30 | |
| | 26.70 | 130.0 | 28.20 | 25.40 | 35.00 | 3.000 | 44.40 | | 22.30 | 88.90 | | |
| 1 | 1.315 | 5.880 | 1.380 | 1.120 | 1.620 | 0.120 | 2.060 | 4 | 1.000 | 4.000 | 3.40 | |
| | 33.40 | 149.3 | 35.10 | 28.40 | 41.10 | 3.000 | 52.30 | | 25.40 | 101.6 | | |
| 1 1/4 | 1.660 | 6.250 | 1.720 | 1.120 | 1.620 | 0.190 | 2.500 | 4 | 1.000 | 4.380 | 3.85 | |
| | 42.20 | 158.7 | 43.70 | 28.40 | 41.10 | 4.800 | 63.50 | | 25.40 | 111.2 | | |
| 1 1/2 | 1.900 | 7.000 | 1.970 | 1.250 | 1.750 | 0.250 | 2.750 | 4 | 1.120 | 4.880 | 5.28 | |
| | 48.30 | 177.8 | 50.00 | 31.70 | 44.40 | 6.400 | 69.85 | | 28.40 | 123.9 | | |
| 2 | 2.375 | 8.500 | 2.460 | 1.500 | 2.250 | 0.310 | 4.120 | 8 | 1.000 | 6.500 | 9.78 | |
| | 60.30 | 215.9 | 62.50 | 38.10 | 57.15 | 7.900 | 104.6 | | 25.40 | 165.1 | | |
| 2 1/2 | 2.875 | 9.620 | 2.970 | 1.620 | 2.500 | 0.310 | 4.880 | 8 | 1.120 | 7.500 | 13.6 | |
| | 73.00 | 244.3 | 75.40 | 41.10 | 63.50 | 7.900 | 123.9 | | 28.40 | 190.5 | | |
| 3 | 3.500 | 9.500 | 3.600 | 1.500 | 2.120 | 0.380 | 5.000 | 8 | 1.000 | 7.500 | 11.3 | |
| | 88.90 | 241.3 | 91.40 | 38.10 | 53.80 | 9.700 | 127.0 | | 25.40 | 190.5 | | |
| 4 | 4.500 | 11.50 | 4.600 | 1.750 | 2.750 | 0.440 | 6.250 | 8 | 1.250 | 9.250 | 19.2 | |
| | 114.3 | 292.1 | 116.8 | 44.40 | 69.85 | 11.20 | 158.7 | | 31.70 | 234.9 | | |
| 5 | 5.563 | 13.75 | 5.690 | 2.000 | 3.120 | 0.440 | 7.500 | 8 | 1.380 | 11.00 | 31.20 | |
| | 141.3 | 349.2 | 114.5 | 50.80 | 79.25 | 11.20 | 190.5 | | 35.00 | 279.4 | | |
| 6 | 6.625 | 15.00 | 6.750 | 2.190 | 3.380 | 0.500 | 9.250 | 12 | 1.250 | 12.50 | 40.50 | |
| | 168.3 | 381.0 | 171.5 | 55.60 | 85.80 | 12.70 | 234.9 | | 31.70 | 317.5 | | |
| 8 | 8.625 | 18.50 | 8.750 | 2.500 | 4.500 | 0.500 | 11.75 | 12 | 1.500 | 15.50 | 71.5 | |
| | 219.1 | 469.9 | 222.3 | 63.50 | 114.3 | 12.70 | 298.4 | | 38.10 | 393.7 | | |
| 10 | 10.75 | 21.50 | 10.92 | 2.750 | 5.000 | 0.500 | 14.50 | 16 | 1.500 | 18.50 | 104 | |
| | 273.0 | 546.1 | 277.4 | 69.85 | 127.0 | 12.70 | 368.3 | | 38.10 | 469.9 | | |
| 12 | 12.75 | 24.00 | 12.92 | 3.120 | 5.620 | 0.500 | 16.50 | 20 | 1.500 | 21.00 | 139 | |
| | 323.8 | 609.6 | 328.2 | 79.25 | 142.7 | 12.70 | 419.1 | | 38.10 | 533.4 | | |
| 14 | 14.00 | 25.25 | 14.18 | 3.380 | 6.120 | 0.500 | 17.75 | 20 | 1.620 | 22.00 | 161 | |
| | 355.6 | 641.3 | 360.2 | 85.80 | 155.4 | 12.70 | 450.8 | | 41.10 | 558.8 | | |
| 16 | 16.00 | 27.75 | 16.19 | 3.500 | 6.500 | 0.500 | 20.00 | 20 | 1.750 | 24.25 | 194 | |
| | 406.4 | 704.8 | 411.2 | 88.90 | 165.1 | 12.70 | 508.0 | | 44.40 | 615.9 | | |
| 18 | 18.00 | 31.00 | 18.20 | 4.000 | 7.500 | 0.500 | 22.25 | 20 | 2.000 | 27.00 | 267 | |
| | 457.2 | 787.4 | 462.3 | 101.6 | 190.5 | 12.70 | 565.1 | | 50.80 | 685.8 | | |
| 20 | 20.00 | 33.75 | 20.25 | 4.250 | 8.250 | 0.500 | 24.50 | 20 | 2.120 | 29.50 | 334 | |
| | 508.0 | 857.2 | 514.4 | 107.9 | 209.5 | 12.70 | 622.3 | | 53.80 | 749.3 | | |
| 24 | 24.00 | 41.00 | 24.25 | 50.50 | 10.50 | 0.500 | 29.50 | 20 | 2.620 | 35.50 | 618 | |
| | 609.6 | 1041.4 | 616.0 | 139.7 | 266.7 | 12.70 | 749.3 | | 66.55 | 901.7 | | |

Notes

- Weights are based on manufacturer's data and are approximate.
- For tolerances see page 8-4.